

THE CORPORATION OF
TOWNSHIP OF WHITEWATER REGION

BY-LAW NUMBER # 11-12-519

A By-law to amend By-law Number 98-13 of the former Corporation of the Township of Westmeath as amended.

PURSUANT TO SECTION 34 OF THE PLANNING ACT, THE TOWNSHIP OF WHITEWATER REGION HEREBY ENACTS AS FOLLOWS:

1. THAT By-law Number 98-13, as amended, be and the same is hereby further amended as follows:
 - (a) By deleting in its entirety the provisions of subsection 19.3(h) Waterfront Vicinity-Exception Eight (WV-E8) to Section 19.3 – Requirements for Waterfront Vicinity (WV) Zone, and replacing it with the following:

“(h) Waterfront Vicinity-Exception Eight (WV-E8)

Notwithstanding anything in this By-law to the contrary, for those lands located in part of Lot 30, Concession East Front B, geographic Township of Westmeath, and delineated as Waterfront Vicinity-Exception Eight (WV-E8), as shown on Schedule “A” (Map 5) to this By-law, no buildings or structures shall be permitted and the minimum required lot frontage shall be 20 metres.”

- (b) Schedule “A” (Map 5) attached hereto, replaces Schedule “A” (Map 5) to By-law 98-13 showing the detailed zoning of Waterfront Vicinity-Exception Eight (WV-E8), Waterfront Vicinity-Thirty-Seven-holding (WV-E37-h) and the Waterfront Vicinity (WV) for the peninsula lands.
2. THAT save as aforesaid all other provisions of By-law 98-13 as amended, shall be complied with.
3. This by-law shall come into force and take effect on the day of final passing thereof.

This By-law given its FIRST and SECOND reading this 14 day of December, 2011.

This By-law read a THIRD time and finally passed this 14 day of December, 2011.



MAYOR



CAO/CLERK

SCHEDULE 'A' (Map 5)

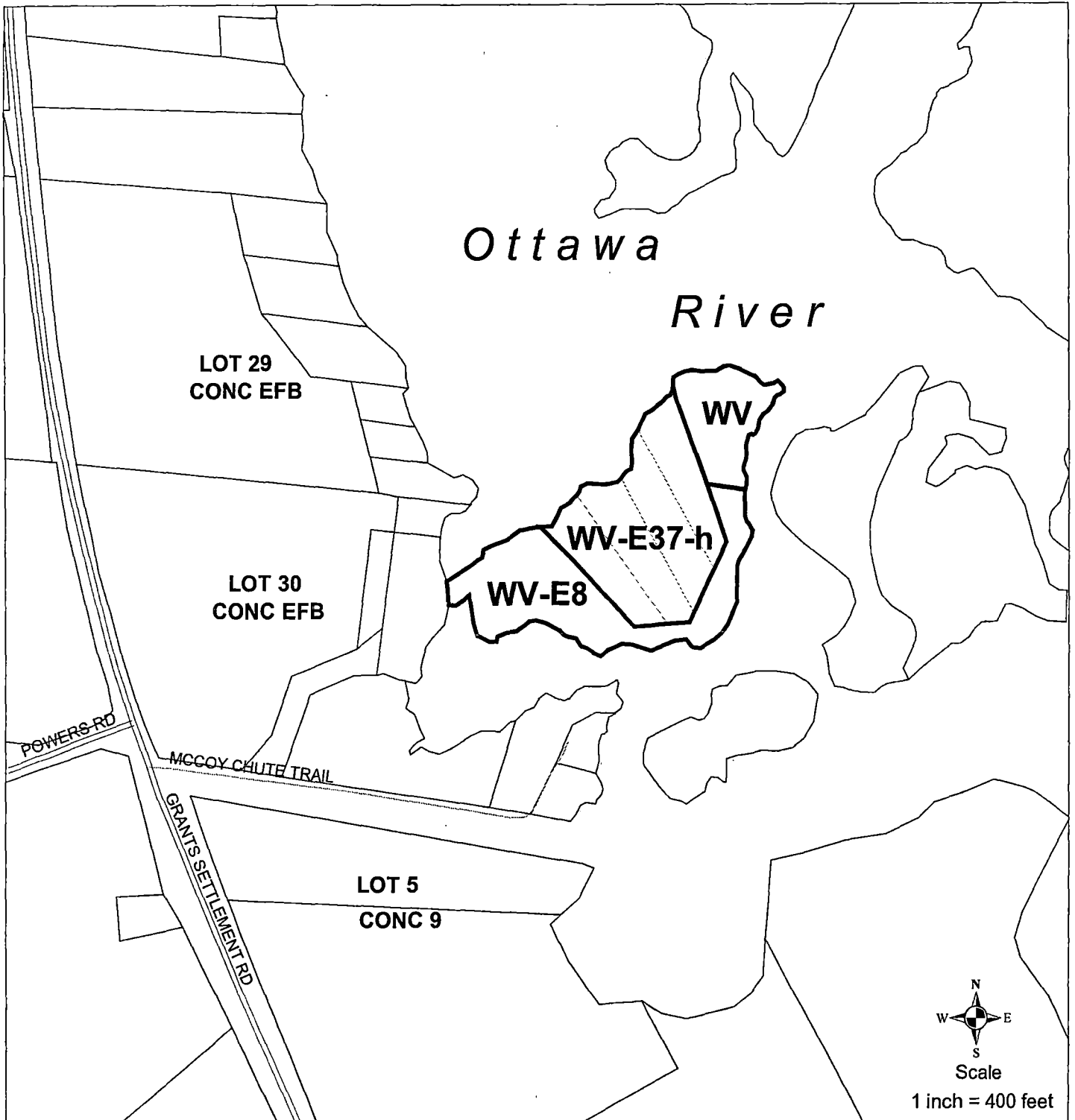

**CORPORATION OF THE
TOWNSHIP OF WHITEWATER REGION**

This is Schedule "A" to By-law Number 11-12-519
which is hereby added to By-law 98-13 as Schedule A (Map 5).

Passed the 14th day of December, 2011.

Signatures of Signing Officers:

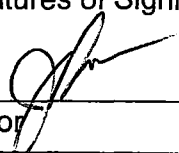

Mayor



CAO/Clerk

LEGEND

- WV** Waterfront Vicinity Zone
- E** Exception Zone
- h** Holding Zone